



One BIN only
for a CCT range



Lifetime



Certified



Certified



Certified



Warranty

FN-2016A-240-12



FN-2016A-266-24



Features

- Super bright 2016 LEDs
- Epistar chips, LM-80 tested
- Ra90+
- Cutable every 3、 6 or 7 LEDs
- Luminous uniform, soft light, no dark area
- Excellent flexibilit and small size,bending radius should be greater than 2.5cm
- cULus Listed, 5 years warranty

Application

Interior lighting, entertainment venues, and shopping malls, etc

Installation

Fix by 3M self adhesive tape



Optical & Electrical Parameters

Model No.	Light Color	Color Temperature(K)	Beam Angle	Luminous Flux (lm/m)	Ra	Efficacy (lm/W)	Voltage (V DC)	Power (W/m)
FN2016A-120-12	White	1900-100000	120°	810-1452	90+	80	12	14.4
FN2016A-120-24	White	1900-100000	120°	810-1452	90+	80	24	14.4
FN2016A-240-12	White	1900-100000	120°	896-1760	90+	80	12	17.28
FN2016A-240-24	White	1900-100000	120°	896-1760	90+	80	24	17.28
FN2016A-266-24	White	1900-100000	120°	990-1950	90+	80	24	16.42

Other Parameters

Model No.	LED Quantity (pcs/m)	Standard Packing Length L*W(mm)	Max Run	Min Cuttable Length(mm)	Working Temperature	Storage Temperature
FN2016A-120-12	120	5000X10	3.5m single ended 7m double ended	25	-25~+60°C	-25~+70°C
FN2016A-120-24	120	5000X10	5m single ended 10m double ended	50	-25~+60°C	-25~+70°C
FN2016A-240-12	240	5000X10	2.5m single ended 5m double ended	12.5	-25~+60°C	-25~+70°C
FN2016A-240-24	240	5000X10	4.5m single ended 9m double ended	25	-25~+60°C	-25~+70°C
FN2016A-266-24	266	5000X14	4m single ended 8m double ended	26.3	-25~+60°C	-25~+70°C

NOTE:

- Test environment temperature : 25±2°C.
- The above data is typical values. The actual data of each single product may differ from the typical values. The data is subject to change without notice.
- Different color temperature will make luminous flux different.
- The Luminous Flux here is tested with single light on .
- Power tolerance within ±10%.



Profile Drawings

Unit:mm

1. FN2016A-120-12/24

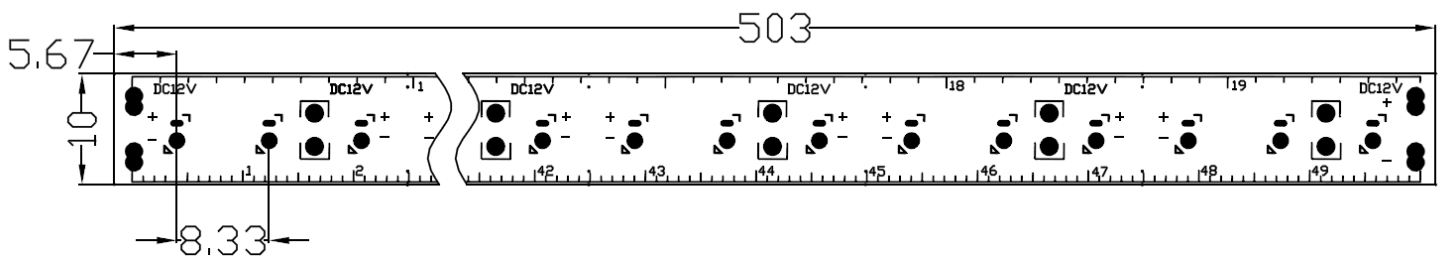

2. FN2016A-240-12/24

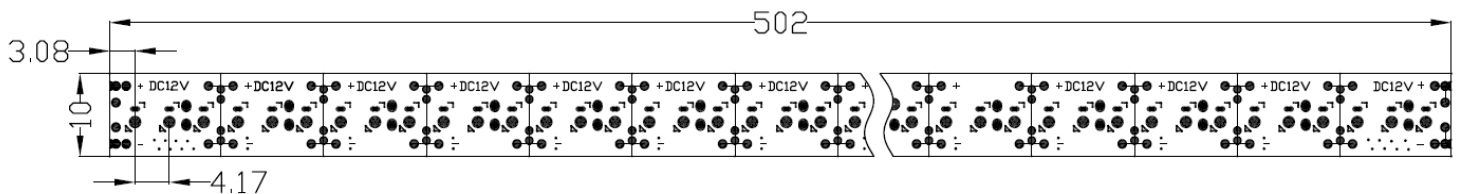

3. FN2016A-266-24

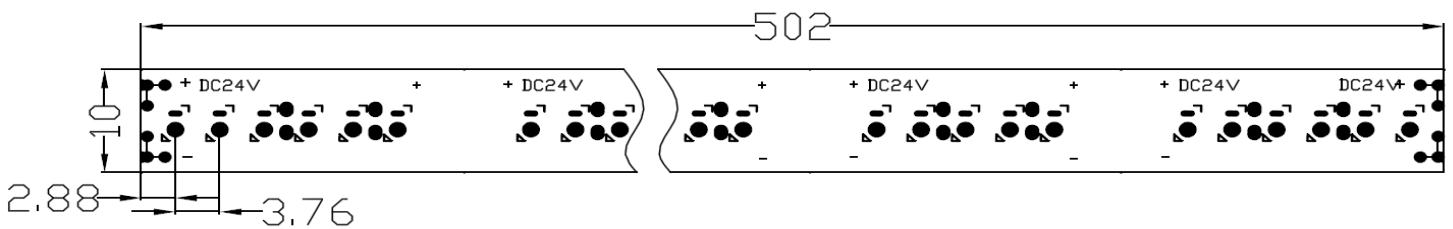



Packaging Information



Roll the product neatly on the reel

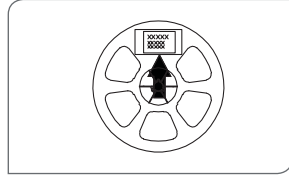

Label the reel;

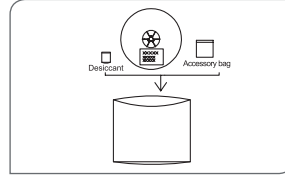

Put reel, accessory bag and desiccant together into aluminium foil bag ;

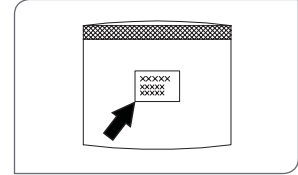

Seal and label the aluminium foil bag ;

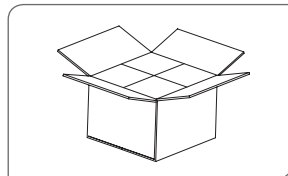

Put the packed aluminium foil bag into carton box;

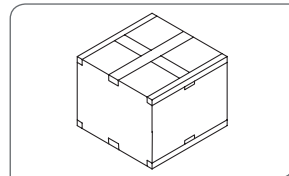

Seal the carton box;

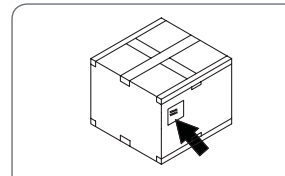

Label the box;

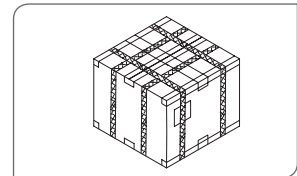

Use packing belt to pack. Add edge protectors if necessary.

Note:This product is sealed and packaged with rolled aluminum foil bag, and packed in export medium box

Packaging information

Model No.	Product Size (mm)	Carton Size (mm)	Meter/Reel	Reel/Carton	Net Weight(kg)	Gross Weight(kg)
FN2016A-120-12	5000*10	550*400*340	5	100	8.5(1±10%)	13.03(1±10%)
FN2016A-120-24	5000*10	550*400*340	5	100	8.5(1±10%)	13.03(1±10%)
FN2016A-240-12	5000*10	550*400*340	5	100	9.3(1±10%)	13.83(1±10%)
FN2016A-240-24	5000*10	550*400*340	5	100	9.3(1±10%)	13.83(1±10%)
FN2016A-266-24	5000*10	550*400*340	5	100	9.5(1±10%)	14.03(1±10%)

Note:The above quantity and weight are only for the illustrated packaging method. There will be differences in the quantity and weight with other packaging methods.

Attentions

Attentions before installation

- Before installation, check that the product parameters are consistent with the requirements (Seeing product specifications or product labels)
- Load voltage, current, power and power supply should be matched with the product.
- Follow the instructions of wiring diagram (first connect the product and then the power supply) to avoid short circuit.
- Make sure the correct connection of positive and negative poles between the product and power supply. Otherwise, the light will not be on.
- Make sure the power cord firmly screwed into the terminal and it should not be pulled out by hands.
- The terminal should have insulation, waterproof and anti-corrosive treatment.
- If the working length exceeded the max run length, make sure to have extra power supply.
- If it needs higher current of a LED, make sure having extra cooling.



Common Faults and Troubleshoot

Quick Guide		
Problems	Reasons	Solutions
All LEDs can not light on.	No electric supply.	Fix the short circuit problem.
	Automatic power protection from the open or short circuit in output of the power supply.	Fix the short circuit problem.
	Wrong connection of power supply.	
LEDs can not light on partly.	Some switching mode power supplies are not powered.	Check the power supply system to fix it.
	Power supply line error.	
	Mistaken wire connection of some of products	Correctly connection
Brightness of LED is inconsistent for insufficient.	Power overloaded.	Replace with more powerful power
	Power supply circuit excessive consumption.	Make sure the working voltage of the product within $\pm 5\%$ of standard voltage, or keep balance by circuit power consumption.
	Excessive quantities in series connection of the product	Reduce the quantities of the product in series connection to meet requirement.
LED flicker.	Connection point fault.	Remove bad connection point.
	Switching power supply failure.	Replace a new power supply.
	Wrong Installation or use of products	Please follow the instructions

Warning

- Do not disassemble or retrofit the light. Do not touch the surface of the light with a sharp object.
- Do not do live-line working during installation, especially for high voltage product.
- Do not use any organic chemical solvents.
- Use neutral glass adhesive to fix this product and it needs to be dried 4 hours in the open environment after operation.
- Treat the ends and the circuit connection points that are not connected to the main line with insulation, waterproof, and anti-corrosion in the installation.
- Use 18AWG (0.75mm² cross-sectional area) or thicker core wire to avoid adverse consequences caused by overheating, if the power cable need to lengthen.
- Make sure the input voltage meets the requirements and lines are connected correctly before lighting on.
- This product is for signage, and do not use as general lighting.
- Series connection within the max run.
- The length of the power cable between the power supply and the led strip should not exceed 2 meters. Otherwise, large circuit loss will lead to inconsistent brightness.
- Installation, maintenance and repair should be operated by a qualified technician.

Statements and Recycling

Statements:

Repair should be operated by a qualified technician, if the external circuit or main line of this product is damaged.
The parameters given in this manual are typical values and for reference only.
All illustrations and drawings in this manual are for reference.
This product is subject to change without notice.

Recycling:

LED lighting products belongs to electronic products, please do recycling treatment according to the relevant WEEE directives.